

Jiava

Jiava

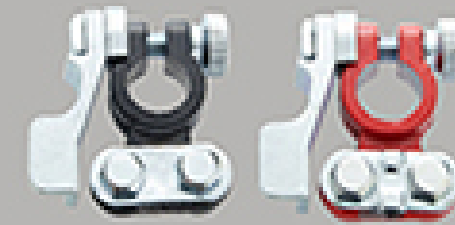
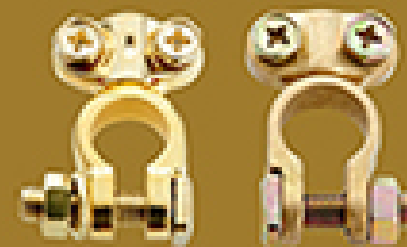

温州嘉驿汽车零部件有限公司
Wenzhou Jiahua Auto Parts Co.,Ltd

电话：86 0577 85239808

传真：86 0577 85239807

地址：中国浙江温州市龙湾区海城街道海城东路58号

邮编：325205

网址：rajiahua.1688.com



温州嘉驿汽车零部件有限公司
Wenzhou Jiahua Auto Parts Co.,Ltd



Company Introduction

嘉祥公司简介 >>>

温州嘉祥汽车部件有限公司成立于2004年，坐落于大海之滨的温州海城，公司专注于蓄电池电缆接头的生产与开发。目前我公司的80%皆出口至欧美各发达国家，与美国“ADWAR NCE AUTOPATS”以及丹麦“RACO”公司都有多年的合作。生产的产品主要以铜、铅、锌等为主体材质。

我们有专业的团队，不屈和共赢的精神，努力为客户提供最高性价比的产品。

Wenzhou Jia Hua auto parts co., LTD., founded in 2004, is located shore of the sea of wenzhou haicheng, the company focused on the production and the development of the battery cable joint. Currently 80% of our company are exported to European and American developed countries, with the United States "ADWAR an NCE AUTOPATS" and "RACO" Danish company has many years of cooperation. The production of Products are mainly in copper, lead, zinc, etc as the main body material.

We have a professional team, unyielding and win-win spirit, efforts to provide customers with the highest cost-effective products.

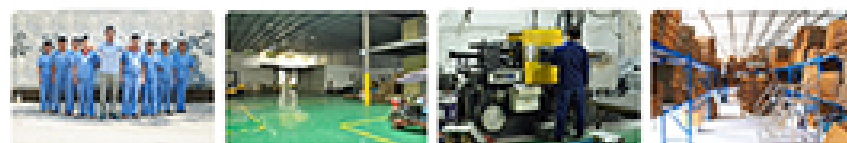

Table of Contents

产品索引 >>>



A

Battery Accessory
电瓶附件

Page01



B

Brass Battery Terminal
黄铜蓄电池接头

Page07



C

Lead Battery Terminal
铅蓄电池接头

Page12



D

Zinc Battery Terminal
锌蓄电池接头

Page16





型号/Model: BA850

- CIG Socket - 4
- Dual USB - 3
- High Current Terminal Posts - 1
- Power Isolator - 7
- Voltmeter Display - 5
- DC Power Input 2.5mm - 8
- 10A Circuit Breaker - 9
- High Current Terminal Posts - 2
- Push button switch for Voltmeter Display - 6

- Dual USB Socket
- Plastic CIG Socket
- Rubber waterproof caps attached to both sockets

- A 2.5mm DC power jack must be fitted. A Plastic Jack is preferred.
- A 10A automotive style circuit breaker must be fitted.



型号: BA825
Model:
材料: PP
Material:
外型尺寸: 34X24.5X27cm
Size of the container:
内尺寸: 26X18X20cm
Inside dimension:
重量: 900g
Weight:

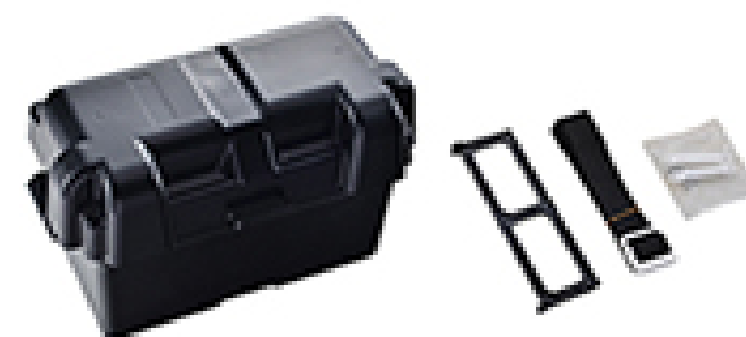

型号: BA826
Model:
材料: PP
Material:
外型尺寸: 44X24.5X27cm
Size of the container:
内尺寸: 35X18X20cm
Inside dimension:
重量: 1100g
Weight:



Battery Accessory
电瓶附件



BA810

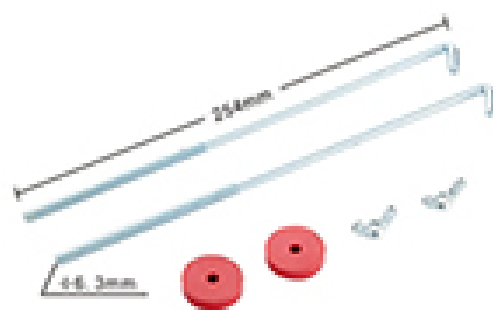

BA811

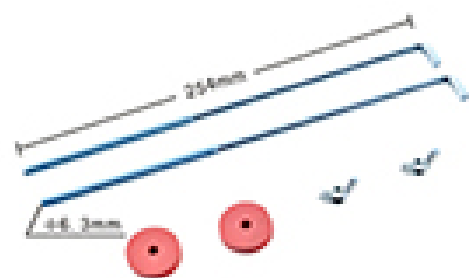

BA812

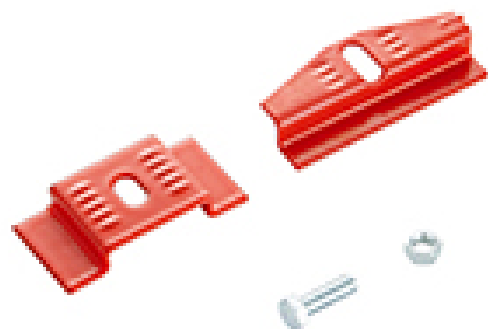

BA813

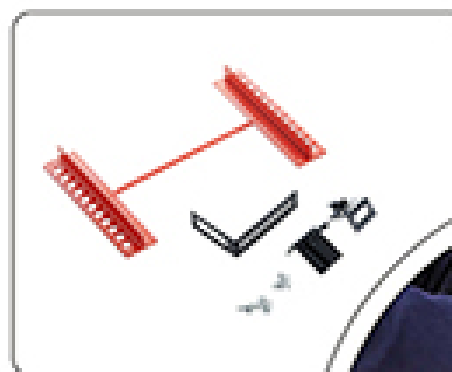

BA814

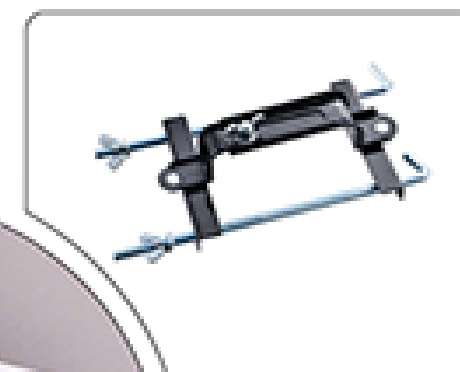

BA835



BA836



BA839



BA815



BA816



BA820

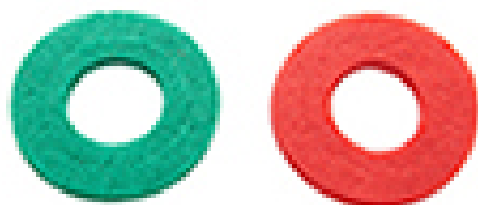

BA821



BA823



BA824



BA818



BA827

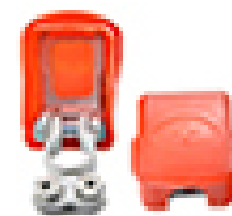

BA833

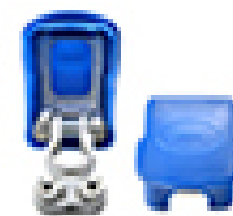

BA834

Battery Switch 电源开关 (高级)

The BA833/BA834 Battery Switch fits top post Batteries.
BA833/BA834电源开关是适用于上面带正负极的蓄电池。

1. Manufactured of copper-zinc plated steel and brass.
1. 由黄铜和镀黄铜制成。
2. Fits side post batteries with standard post adapters.
2. 适用于 "top"和 "side"型 (加一个装置器) 的电瓶夹。
3. Attach to battery terminal by clamping down of the cap, lift cap to remove from battery terminal.
3. 按下电源开关, 拉起来电源断开。
4. RoHS Compliant, Fits 4 to 6 gauge wires.
4. 环保认证, 可接AWG4-6号线。





BA830

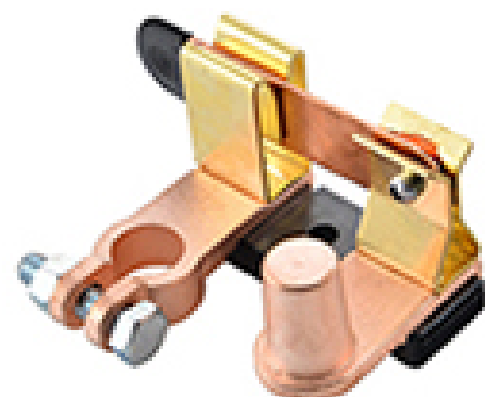

BA831



BA832

Knife-blade Switch 闸刀开关

The BA830/BA831/BA832 knife-blade switches. This range gives a very compact, versatile solution.

BA830/BA831/BA832是一款专门装配在投控板上的闸刀开关，有很多独一无二的性能：

1. Mount on negative battery post, Disconnect batteries quickly and easily.
1. 装在负极蓄电池上，开和关非常简便。
2. Stop unwanted battery drain. Help prevent theft, tampering and unauthorized use.
2. 防止不必要的耗电，以及避免未经授权的使用。
3. Improve safety and security of stored vehicles, RVs and seasonal equipment.
3. 改善汽车，保证水上工具和家庭大型设备安全。



BT203



BT204



BT219



BT220

Main Technical Data/主要技术数据

型号 Part NO.	材料 Used name	镀锌处理 Bolt C.	适用电线 mm ²	尺寸 Size	备注 Note
BT203	H59	TIN	35-50	19	RoHS
BT204	H59	TIN	35-50	17.5	RoHS
BT219	H59	TIN	35-50	15	RoHS
BT220	H59	TIN	35-50	13	RoHS



BT235



BT236



BT239



BT240

Main Technical Data/主要技术数据

型号 Part NO.	材料 Used name	镀锌处理 Bolt C.	适用电线 mm ²	尺寸 Size	备注 Note
BT235	H59	TIN	35-90	19	RoHS
BT236	H59	TIN	35-90	17.5	RoHS
BT239	H59	TIN	35-90	19	RoHS
BT240	H59	TIN	35-90	17.5	RoHS



Main Technical Data/主要技术数据

型号 Part NO.	材料 Used name	镀层处理 Bolt C.	适用电线 mm ²	尺寸 Size	备注 Note
BT245	H59	TIN	25-35	19	Heavy-Duty
BT246	H59	TIN	25-35	17.5	Heavy-Duty
BT247	H59	TIN	35-50	19	Heavy-Duty
BT248	H59	TIN	35-50	17.5	Heavy-Duty



Main Technical Data/主要技术数据

型号 Part NO.	材料 Used name	镀层处理 Bolt C.	适用电线 mm ²	尺寸 Size	备注 Note
BT261	H62	Zinc	35-50	19	RoHS
BT262	H62	Zinc	35-50	17.5	RoHS
BT263	H62	Zinc	50-70	19	RoHS
BT264	H62	Zinc	50-70	17.5	RoHS



Main Technical Data/主要技术数据

型号 Part NO.	材料 Used name	镀层处理 Bolt C.	适用电线 mm ²	尺寸 Size	备注 Note
BT205	H59	TIN	25-35	19	7.1mm
BT206	H59	TIN	25-35	17.5	7.1mm
BT207	H59	TIN	35-50	19	9.0mm
BT208	H59	TIN	35-50	17.5	9.0mm

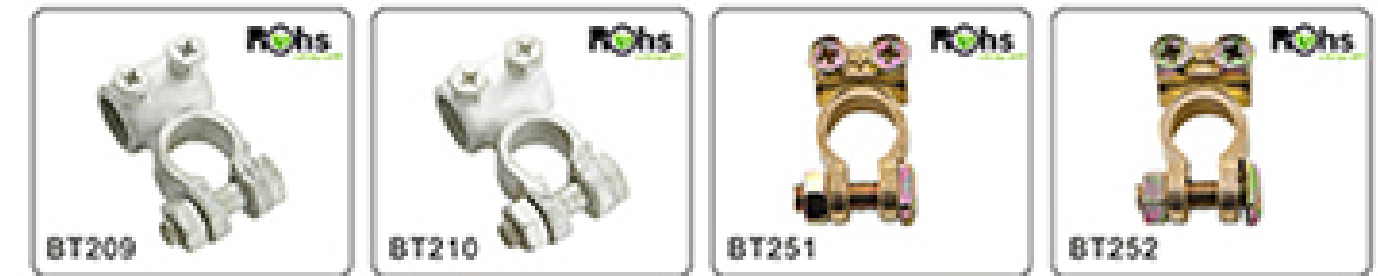

Main Technical Data/主要技术数据

型号 Part NO.	材料 Used name	镀层处理 Bolt C.	适用电线 mm ²	尺寸 Size	备注 Note
BT209	H59	TIN	50-90	19	12mm
BT210	H59	TIN	50-90	17.5	12mm
BT251	H59	Zinc	35-50	19	9.0mm
BT252	H59	Zinc	35-50	17.5	9.0mm



Main Technical Data/主要技术数据

型号 Part NO.	材料 Used name	螺栓处理 Bolt C.	适用电线 mm ²	尺寸 Size	备注 Note
BT227	H59	TIN	25-70	19	Stud M10
BT228	H59	TIN	25-70	17.5	Stud M10
BT227V	H59	TIN	25-70	19	Stud M10
BT228V	H59	TIN	25-70	17.5	Stud M10

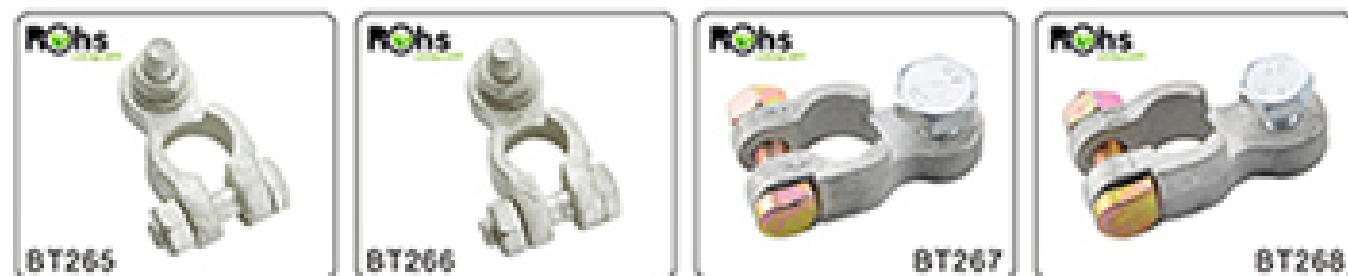

Main Technical Data/主要技术数据

型号 Part NO.	材料 Used name	螺栓处理 Bolt C.	适用电线 mm ²	尺寸 Size	备注 Note
BT265	H59	TIN	25-70	19	Stud M8
BT266	H59	TIN	25-70	17.5	Stud M8
BT267	H59	TIN	25-70	19	Stud M10
BT268	H59	TIN	25-70	17.5	Stud M8



Main Technical Data/主要技术数据

型号 Part NO.	材料 Used name	螺栓处理 Bolt C.	适用电线 mm ²	尺寸 Size	备注 Note
BT249	H59	Zinc	25-35	19	
BT250	H59	Zinc	25-35	17.5	
BT260	H59	Brass	25-35	18	Universal
BT285	H59	Golden	25-35	18	Universal



Main Technical Data/主要技术数据

型号 Part NO.	材料 Used name	螺栓处理 Bolt C.	适用电线 mm ²	尺寸 Size	备注 Note
BT282	H62	Zinc	25-35	19	Universal
BT280	H62	Zinc	25-35	19	Universal
BT283	H62	Zinc	25-35	19	
BT284	H62	Zinc	25-35	17.5	



Main Technical Data/主要技术数据

型号 Part NO.	材料 Used name	镀锌处理 Bolt C.	适用电线 mm ²	尺寸 Size	备注 Note
BT101	Lead	Zinc	12-25	14	
BT105-90	Lead	Zinc	25-35	18	90g
BT105-100	Lead	Zinc	25-35	18	100g
BT105-110	Lead	Zinc	25-35	18	110g



Main Technical Data/主要技术数据

型号 Part NO.	材料 Used name	镀锌处理 Bolt C.	适用电线 mm ²	尺寸 Size	备注 Note
BT106	Lead	Zinc	25-35	19	120g
BT107	Lead	Zinc	25-35	17.5	120g
BT108	Lead	Zinc	25-35	18	Universal
BT136	Lead	Zinc	25-35	18	Universal



Main Technical Data/主要技术数据

型号 Part NO.	材料 Used name	镀锌处理 Bolt C.	适用电线 mm ²	尺寸 Size	备注 Note
BT110	Lead	Zinc	25-35	17.5	100g
BT111	Lead	Zinc	25-35	19	100g
BT112	Lead	Zinc	25-35	17.5	120g
BT113	Lead	Zinc	25-35	19	120g



Main Technical Data/主要技术数据

型号 Part NO.	材料 Used name	镀锌处理 Bolt C.	适用电线 mm ²	尺寸 Size	备注 Note
BT114	Lead	Zinc	25-70	17.5	
BT115	Lead	Zinc	25-70	19	
BT116	Lead	Zinc	25-35	17.5	
BT117	Lead	Zinc	25-35	19	



Main Technical Data/主要技术数据

型号 Part NO.	材料 Used name	螺栓处理 Bolt C.	适用电线 mm ²	尺寸 Size	备注 Note
BT120	Lead	Zinc	25-35		
BT121	Lead	Zinc	25-35		
BT130	Lead	Zinc	25-50	19	
BT131	Lead	Zinc	25-50	17.5	



Main Technical Data/主要技术数据

型号 Part NO.	材料 Used name	螺栓处理 Bolt C.	适用电线 mm ²	尺寸 Size	备注 Note
BT134	Lead	Zinc	25-50	17.5	
BT135	Lead	Zinc	25-50	17.5	
BT137	Lead	Zinc	25-50	19	
BT138	Lead	Zinc	25-50	17.5	



Main Technical Data/主要技术数据

型号 Part NO.	材料 Used name	螺栓处理 Bolt C.	适用电线 mm ²	尺寸 Size	备注 Note
BT141	Lead			19	3/8"Bolt
BT142	Lead			17.5	3/8"Bolt
BT143	Lead			19	3/8"Thread
BT144	Lead			17.5	3/8"Thread

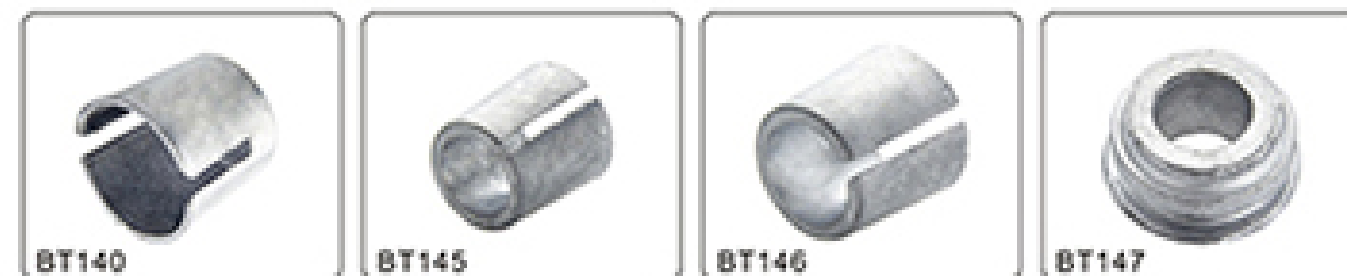

Main Technical Data/主要技术数据

型号 Part NO.	材料 Used name	螺栓处理 Bolt C.	适用电线 mm ²	尺寸 Size	备注 Note
BT140	Lead			19	0.5gmmThin
BT145	Lead			19	
BT146	Lead			17.5	
BT147	Lead				9mm

Zinc Battery Terminal 锌蓄电池接头



Main Technical Data/主要技术数据

型号 Part NO.	材料 Used name	表面处理 Body C.	适用电线 mm ²	尺寸 Size	备注 Note
BT304	Zinc	Cope	35-50	17.5	
BT305	Zinc	Cope	35-50	19	
BT306	Zinc	Brass	35-50	17.5	
BT307	Zinc	Brass	35-50	19	



Main Technical Data/主要技术数据

型号 Part NO.	材料 Used name	表面处理 Body C.	适用电线 mm ²	尺寸 Size	备注 Note
BT308	Zinc	Brass	35-50	17.5	
BT309	Zinc	Brass	35-50	19	
BT317	Zinc	Brass	35-70	19	
BT318	Zinc	Brass	35-70	17.5	

Zinc Battery Terminal 锌蓄电池接头

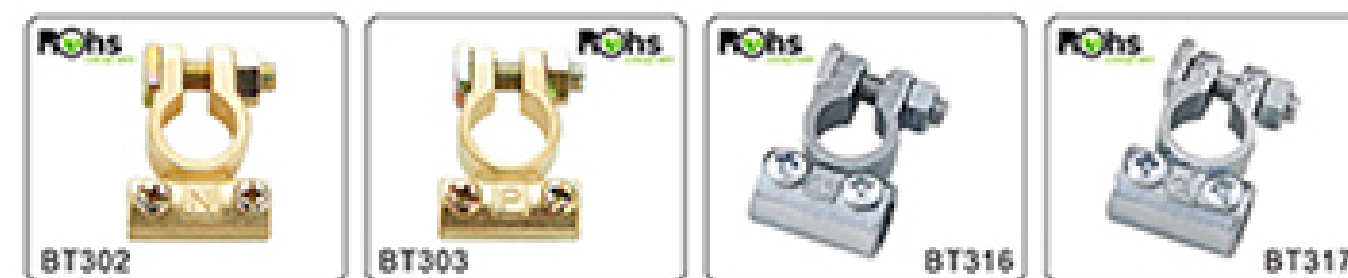

Main Technical Data/主要技术数据

型号 Part NO.	材料 Used name	表面处理 Body C.	适用电线 mm ²	尺寸 Size	备注 Note
BT302	Zinc	Brass	25-35	17.5	
BT303	Zinc	Brass	25-35	19	
BT316	Zinc	Zinc	25-50	17.5	
BT317	Zinc	Zinc	35-50	19	



Main Technical Data/主要技术数据

型号 Part NO.	材料 Used name	表面处理 Body C.	适用电线 mm ²	尺寸 Size	备注 Note
BT312	Zinc	Brass	35-50	17.5	
BT313	Zinc	Brass	35-50	19	
BT310	Zinc	Brass	35-50	17.5	
BT311	Zinc	Brass	35-50	19	

Zinc Battery Terminal 锌蓄电池接头



Main Technical Data/主要技术数据

型号 Part NO.	材料 Used name	表面处理 Body C.	适用电线 mm ²	尺寸 Size	备注 Note
BT300	Zinc	Cope	15-25	14	
BT301	Zinc	Zinc	25-35	18	
BT314	Zinc	Cope	25-35	18	
BT315	Zinc	Zinc	25-35	18	



Main Technical Data/主要技术数据

型号 Part NO.	材料 Used name	表面处理 Body C.	适用电线 mm ²	尺寸 Size	备注 Note
BT321	Zinc	Zinc	35-50	18	
BT322	Zinc	Zinc	35-50		
BT322	Zinc	Zinc	35-70	18	
BT324	Zinc	Zinc	35-70	18	



SW001



Weight: 318g
Material: ABS,brass bolt and nut, iron washer
Electrical Connection Studs: M12
Feet spacing :30 mm
Mounting Holes:M6(6mm)
Mounting spacing range :31-55mm
Round disk diameter: 6cm
Overall dimensions:10*6cm
Working Capacity: 100 AMPS
MAX Current: 2000AMPS
Voltage:12v/24v/36v

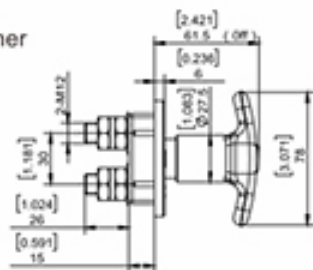

SW002



weight: 126g
Material: ABS,brass bolt , iron nut, iron washer
Electrical Connection Studs: M10
Feet spacing :33 mm
Mounting Holes:M6 (Two)
Mounting spacing range :32-44mm
Round disk diameter: 5.7cm
Overall dimensions:10*5.7cm
Working Capacity: 100 AMPS
MAX Current: 2000AMPS
Voltage:12v/24v/36v

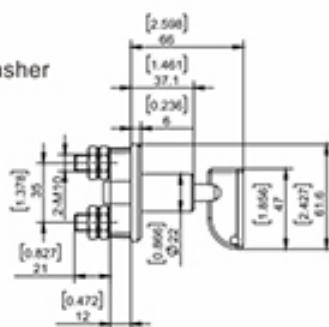

SW003



weight:124g
Material: ABS,brass bolt , iron nut, iron washer
Electrical Connection Studs: M10
Feet spacing :33 mm
Mounting Holes:M6 (four)
Round disk diameter: 6cm
Overall dimensions:10*6cm
Working Capacity: 100 AMPS
MAX Current: 200AMPS
Voltage:12v/24v

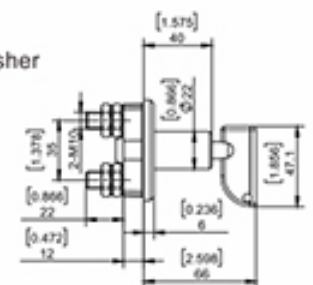

SW004



weight: 174g
Material: ABS,brass bolt , iron nut, iron washer
Electrical Connection Studs: M10
Feet spacing :34 mm
Mounting Holes:M6 (TWO)
Overall dimensions:12*12cm
Voltage:12v/24v/36v
Working Capacity: 100 AMPS
MAX Current: 2000AMPS

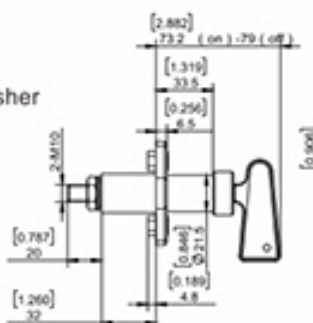

SW005



weight: 189g
Material: ABS,brass bolt , Brass nut, iron washer
Electrical Connection Studs: M10
Feet spacing :34 mm
Mounting Holes:M8 (TWO)
Overall dimensions:13*9cm
Working Capacity: 100 AMPS
MAX Current: 2000AMPS
Voltage:12v/24v/36v

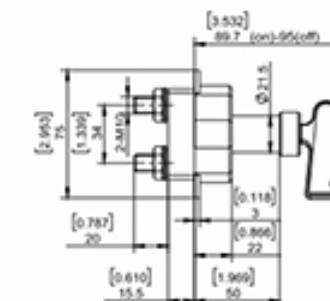

SW006



weight: 260g
Material: ABS,brass bolt ,Iron nut, iron washer
Electrical Connection Studs: M10
Feet spacing :40 mm
Mounting Holes:M4 (TWO)
Overall dimensions:12*12cm
Working Capacity: 100 AMPS
MAX Current: 2000AMPS
Voltage:12v/24v/36v

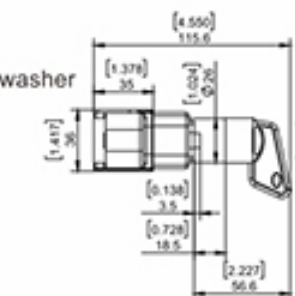

SW007



weight: 243g
Material: ABS,brass bolt , Iron nut, iron washer
Electrical Connection Studs: M10
Feet spacing :42 mm
Mounting Holes:M5 (TWO)
Overall dimensions:13*9cm
Working Capacity: 100 AMPS
MAX Current: 2000AMPS
Voltage:12v/24v/36v

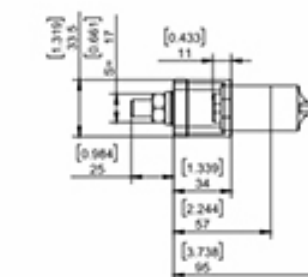

SW008



weight: 350g
Material: AL Body ,brass bolt , iron nut, iron washer
Electrical Connection Studs: M10
Feet spacing :40 mm
Mounting Holes:M8 (TWO)
Overall dimensions:13.5*9.5cm
Working Capacity: 100 AMPS
MAX Current: 2000AMPS
Voltage:12v/24v/36v

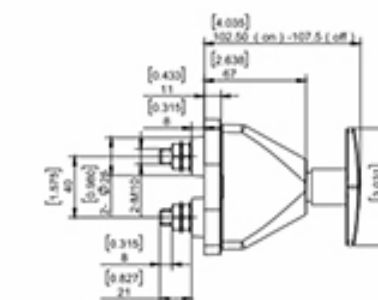

SW009



weight: 394g
Material: zinc Body ,brass bolt ,
Iron nut, iron washer
Electrical Connection Studs: M10
Feet spacing :40 mm
Mounting Holes:M8 (TWO)
Overall dimensions:13.5*9.5cm
Working Capacity: 100 AMPS
MAX Current: 2000AMPS
Voltage:12v/24v/36v

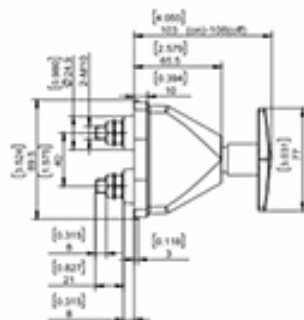

SW010



weight: 432g
Material: zinc Body ,brass bolt ,
Iron nut, iron washer
Electrical Connection Studs: M10
Feet spacing :40 mm
Mounting Holes:M8 (TWO)
Overall dimensions:16.5*9.5cm
Working Capacity: 100 AMPS
MAX Current: 2000AMPS
Voltage:12v/24v/36v

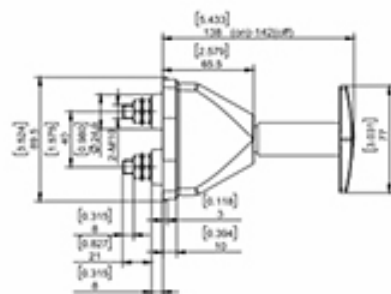

SW011



weight: 298g
Material: AL Body ,brass bolt , Iron nut,
iron washer
Electrical Connection Studs: M10
Feet spacing :32 mm
Mounting Holes:M10 (TWO)
Overall dimensions:16*13cm
Working Capacity: 100 AMPS
MAX Current: 2000AMPS
Voltage:12v/24v/36v

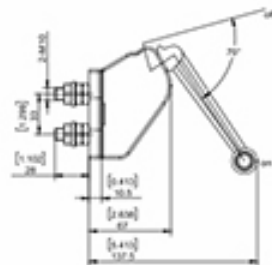

SW012



weight: 172g
Material: ABS Body ,brass bolt , Iron nut, iron washer
Electrical Connection Studs: M10
Feet spacing :33 mm
Mounting Holes:M10 (TWO)
Overall dimensions:11*9cm
Working Capacity: 100 AMPS
MAX Current: 2000AMPS
Voltage:12v/24v/36v

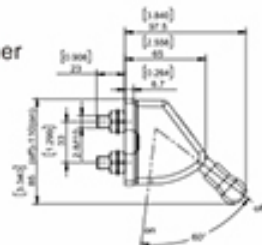

SW013



weight: 207g
Material: ABS key , zinc cover, brass bolt ,
brass nut, iron washer
Electrical Connection Studs: M8
Feet spacing :44 mm
Mounting Holes:M6 (Two)
Mounting spacing range :32-44mm
Round disk diameter: 5.7cm
Overall dimensions:10*5.7cm
Working Capacity: 100 AMPS
MAX Current: 2000AMPS
Voltage:12v/24v/36v

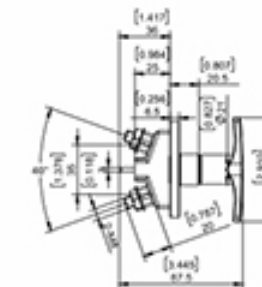

SW014



weight: 881g
Material: Iron Body ,brass bolt ,
brass nut, iron washer
Electrical Connection Studs: M10
Feet spacing :38 mm
Mounting Holes:M10 (four)
Overall dimensions:10*14cm
Working Capacity: 250 AMPS
MAX Current: 2000AMPS
Voltage:12v/24v/36v

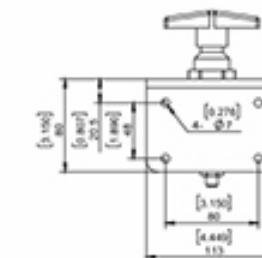

SW015



weight: 170g
Material: ABS,brass bolt and Iron nut, iron washer
Electrical Connection Studs: M10
Feet spacing :33 mm
Mounting Holes:M6(6mm)
Mounting spacing range :31-44mm
Round disk diameter: 6.5cm
Overall dimensions:13*6.5cm
Working Capacity: 100 AMPS
MAX Current: 2000AMPS
Voltage:12v/24v/36v

SW016



weight: 487g
Material: Iron Body ,brass bolt ,
Iron nut, iron washer
Electrical Connection Studs: M10
Feet spacing :34 mm
Mounting Holes:M7 (TWO)
Overall dimensions:12*14cm
Working Capacity: 100 AMPS
MAX Current: 2000AMPS
Voltage:12v/24v/36v